



# INTERNATIONAL ILLUSTRATED PARTS LIST



## MODELS

300NDNL with Fast Timer

For Replacement Parts contact Parts Distributor:  
Parts Town at [www.partstown.com](http://www.partstown.com) or phone 800-438-8898.

For additional information on Thermodyne Foodservice Products, Inc.,  
or to locate an authorized parts and service provider in your area,  
visit our website at [www.tdyne.com](http://www.tdyne.com).

Please visit our website to Register your Thermodyne unit. Registration ensures that you  
get up-to-date warranty and product information, along with fast and convenient service.

<http://www.tdyne.com/register.aspx>

Thermodyne Foodservice Products, Inc.  
4418 New Haven Avenue  
Fort Wayne, IN 46803

1-800-526-9182  
[www.tdyne.com](http://www.tdyne.com)



# TABLE OF CONTENTS

Main Cabinet - Right Side Components..... 4

Main Cabinet - Left Side Components ..... 6

300NDNL with Fast Timer PowerHead Components..... 8

Wire Harness Diagrams ..... 10

# MAIN CABINET - RIGHT SIDE COMPONENTS

1

ITEM NO.	PART NUMBER	DESCRIPTION	QTY.
6	91335	3/8" 1/8" BRASS ELBOWS	10
7	81618	STAINLESS STEEL WASHERS	20
8	91185	NYLON WASHERS	50
9	90445	1/8" BRASS PLUGS	10
21	10190	MANIFOLD BRACKET	2
22	20450	DELIVERY MANIFOLD	1
23	91322SS	12" STAINLESS STEEL FLEX LINE	5
24	91325	3/8" × 1/8" STRAIGHT BRASS FITTING	10
25	91321SS	3/8" × 8" Stainless Steel Flex Line	5
27	20430	OUTER SIDE WALL W/ INSULATION	2
42	90658	5/8" NIPPLE	2
44	91355	30" STAINLESS STEEL FLEX LINE	1
53	90480	POWER CORD GRIP	1
54	91120	230V 14/3 EU CORD W/FUSE	1
55	OUTER WALL INSULATION	OUTER SIDE WALL INSULATION	2
64	90685	QUARTER TURN SCREWS	4

# MAIN CABINET - RIGHT SIDE EXPLODED VIEW

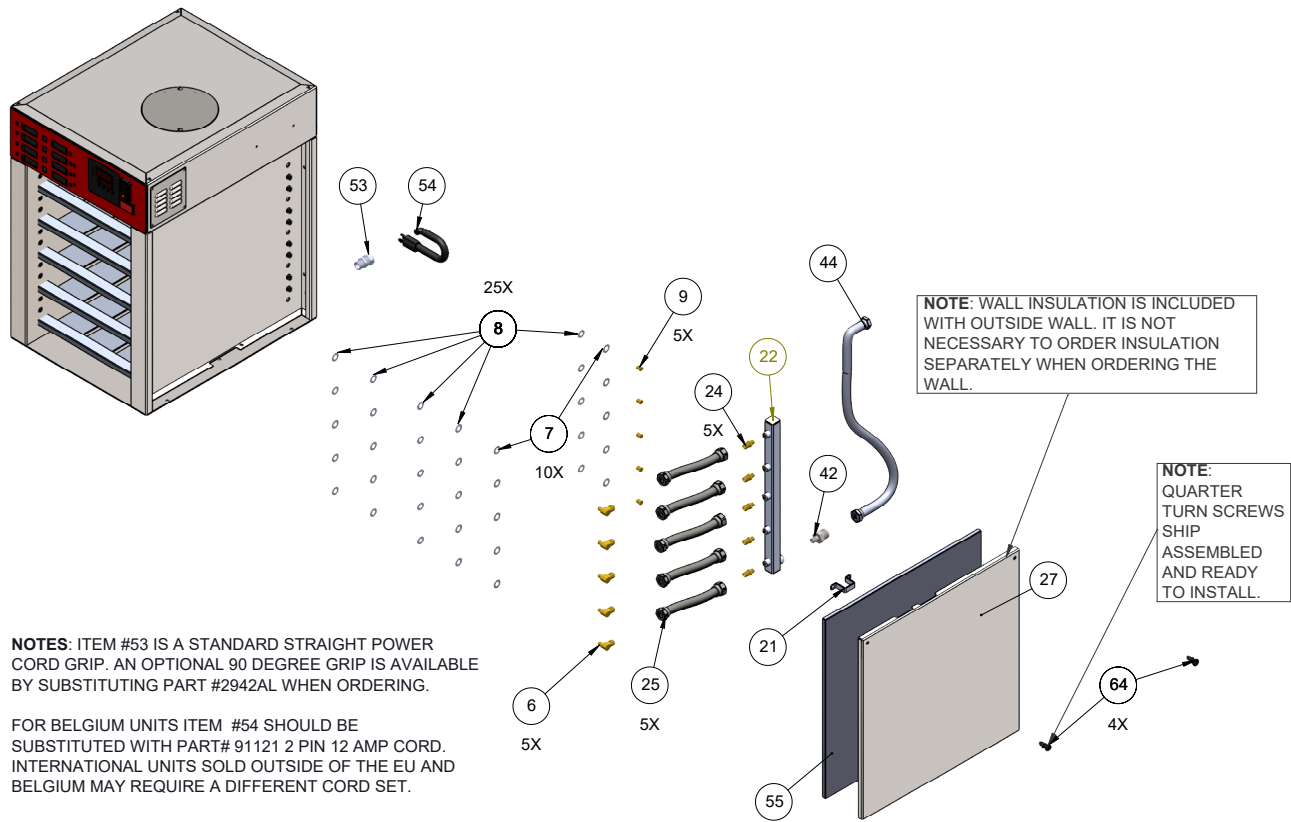

Exploded View 300NDNL with Fast Timer - Right Side

## MAIN CABINET - LEFT SIDE COMPONENTS

ITEM NO.	PART NUMBER	DESCRIPTION	QTY.
4	91220	FLUID SHELVES	5
6	91335	3/8" 1/8" BRASS ELBOWS	10
7	81618	STAINLESS STEEL WASHERS	20
8	91185	NYLON WASHERS	50
9	90445	1/8" BRASS PLUGS	10
10	90446	BLACK PLASTIC DOME PLUGS	36
18	20451	RETURN MANIFOLD	1
19	90775	MANIFOLD GASKET	1
21	10190	MANIFOLD BRACKET	2
23	91322SS	12" STAINLESS STEEL FLEX LINE	5
24	91325	3/8" × 1/8" STRAIGHT BRASS FITTING	10
27	20430	OUTER SIDE WALL W/ INSULATION	2
39	90324	1/4" BRASS HOSE BARB FITTING	2
49	90303	1/4" Ball Drain valve	1
55	OUTER WALL INSULATION	OUTER SIDE WALL INSULATION	2
60	90167-12	3/8" SILICONE HOSE	1
64	90685	QUARTER TURN SCREWS	4
65	20400	BACK PLATE	1

# MAIN CABINET - LEFT SIDE EXPLODED VIEW

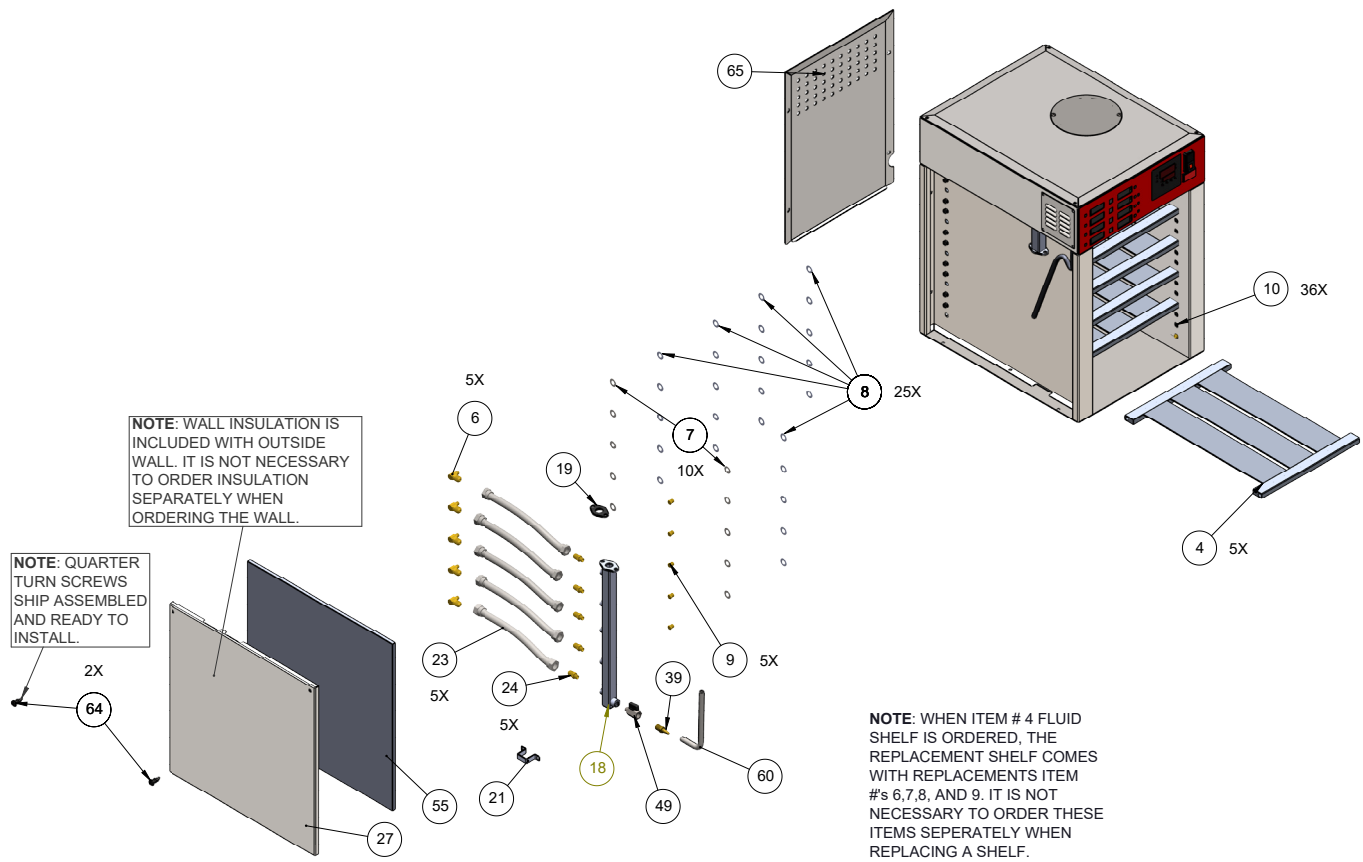

**Exploded View 300NDNL with Fast Timer - Left Side**

## 300NDNL with FAST TIMER POWERHEAD COMPONENTS

ITEM NO.	PART NUMBER	DESCRIPTION	QTY.
1	10140	BASE	1
2	20310	LEFT INNER SIDE WALL	1
3	20320	RIGHT INNER SIDE WALL	1
5	10118	POWER HEAD	1
12	91510	230V FLUID LIGHT	1
13	90419	125V ON/OFF SWITCH	1
14	10110	POWER HEAD LID	1
15	90737	PLASTIC OVERFLOW TANK	1
16	90434	HEATER TANK ASSEMBLY	1
17	90872	EXHAUST FAN 230V	1
26	90810	120 X 1500 HEATER TANK ELEMENTS	2
28	90629	4" FITTING HEATER TANK TO PUMP	1
29	90670	230V 50 HZ PUMP	1
30	90674	3/4" PUMP UNION NUT	2
31	90659	O-RING PUMP GASKET	2
32	90631	90 DEGREE FITTING PUMP TO FLEX LINE	1
33	27967	TANK AND PUMP BRACKET	2
34	90739	PVC OVERFLOW TANK CAP	1
35	90316	THERMOCOUPLE FITTING	1
36	91191	"J" STYLE THERMOCOUPLE	1
37	90486	LIQUID LEVEL PROBES	2
38	90705	HEATER TANK PRESSURE CAP	1
39	90324	1/4" BRASS HOSE BARB FITTING	2
40	90323	Brass Hose Barb 90	1
41	90865	HEATER TANK SAFETY SNAP DISC	1
42	90658	5/8" NIPPLE	2
43	10205	CONTROLS MOUNTING BOARD	1
44	91355	30" STAINLESS STEEL FLEX LINE	1
45	90871	230V LIQUID LEVEL FLOAT BOARD	1
46	90910	SOLID STATE RELAY	1
47	90545	DISTRIBUTION BLOCK	1
48	91158	240V CONTACTOR	1
50	10115	ACCESS COVER	1
51	2110	AIR FLOW DEFLECTOR	1
52	90438	HEATER TANK INSULATION	1
56	10117	CONTROLLER MOUNTING PLATE	1
57	90603	FAST TIMER OVERLAY	1
58	90588	FLUSH MOUNT CONTROLLER	1
59	90590	CONTROLLER LED OVERLAY	1
61	90167-24	3/8" SILICON HOSE	1
62	90167-4	3/8" SILICONE HOSE	1
63	POWERHEAD INSULATION	POWERHEAD INSULATION	1
65	20400	BACK PLATE	1
66	91199	FAST TIMER	1
67	11104-01250	NYLON ACCESS COVER WASHER	1
68	99999NS	#10-32 NYLON SCREW	1
69	90236	ACCESS COVER SS TAMPER PROOF #10-32 SCREW	1



# 300NDNL with FAST TIMER POWERHEAD EXPLODED VIEW

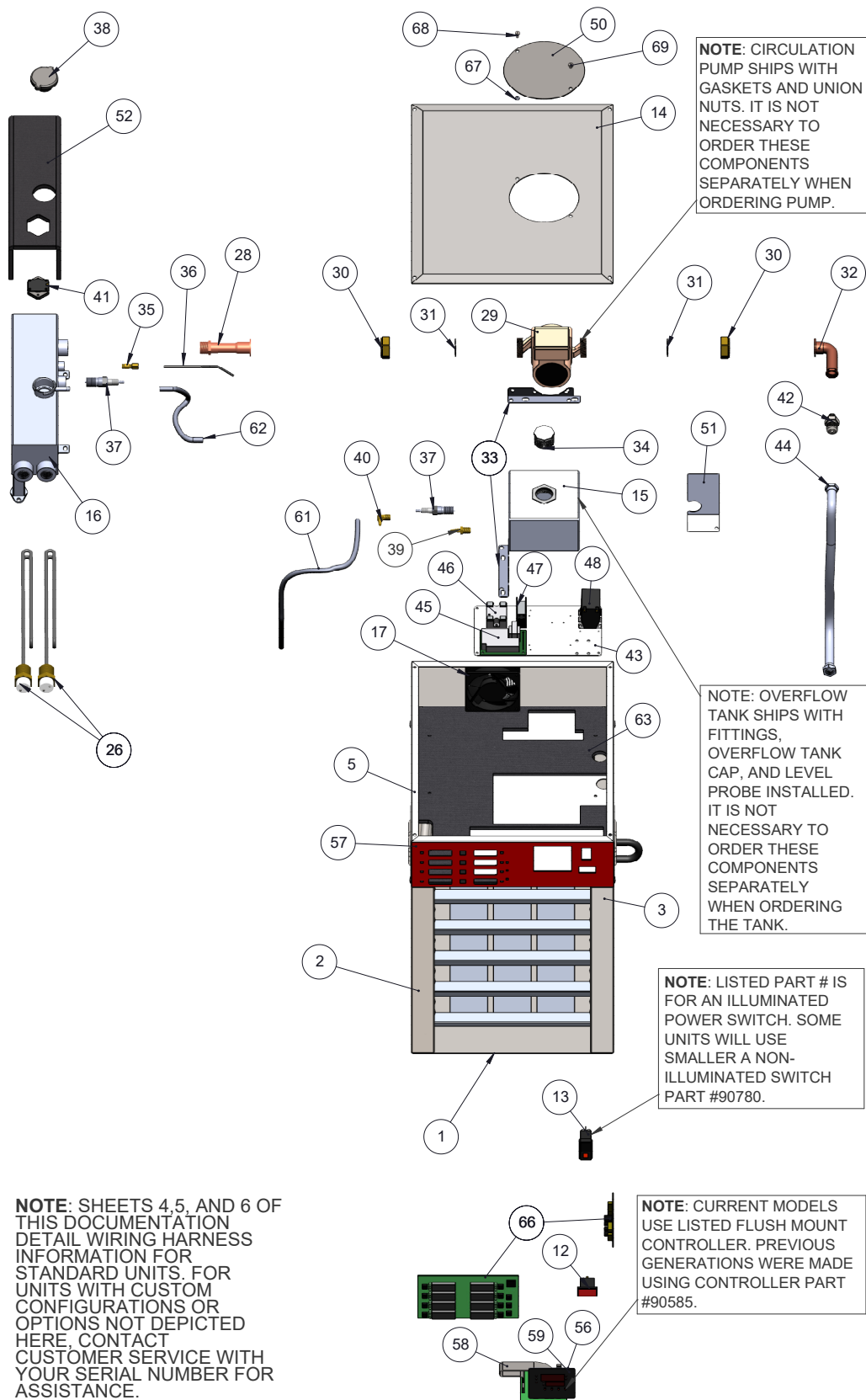

300NDNL with Fast Timer PowerHead Exploded View

# WIRE HARNESS DIAGRAMS

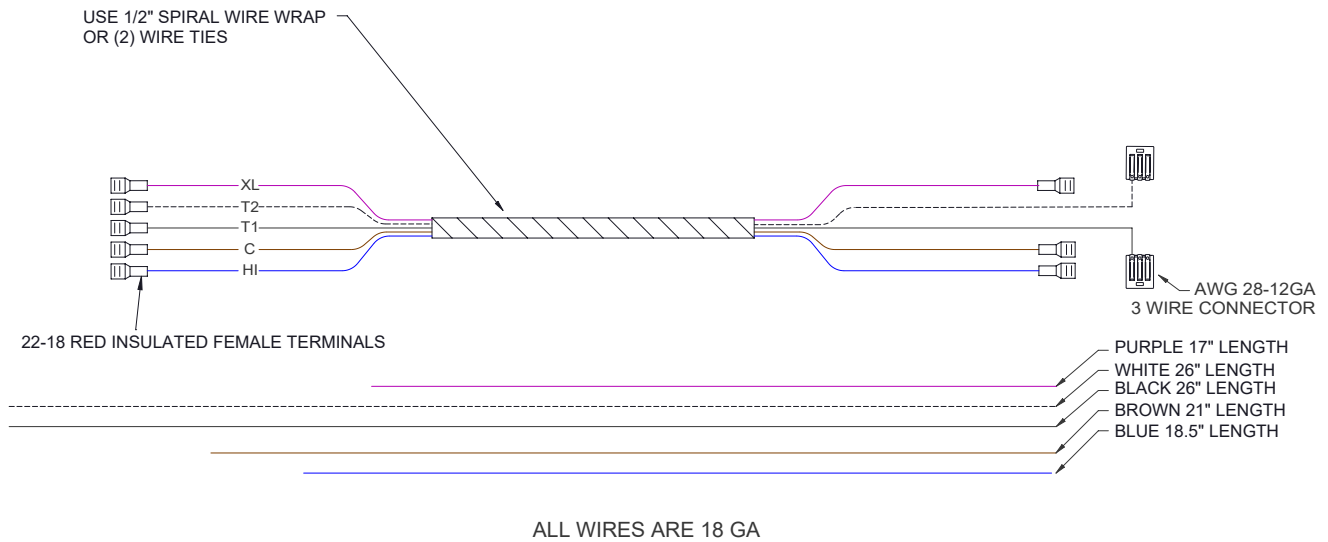

## 90770 Standard Wire Harness

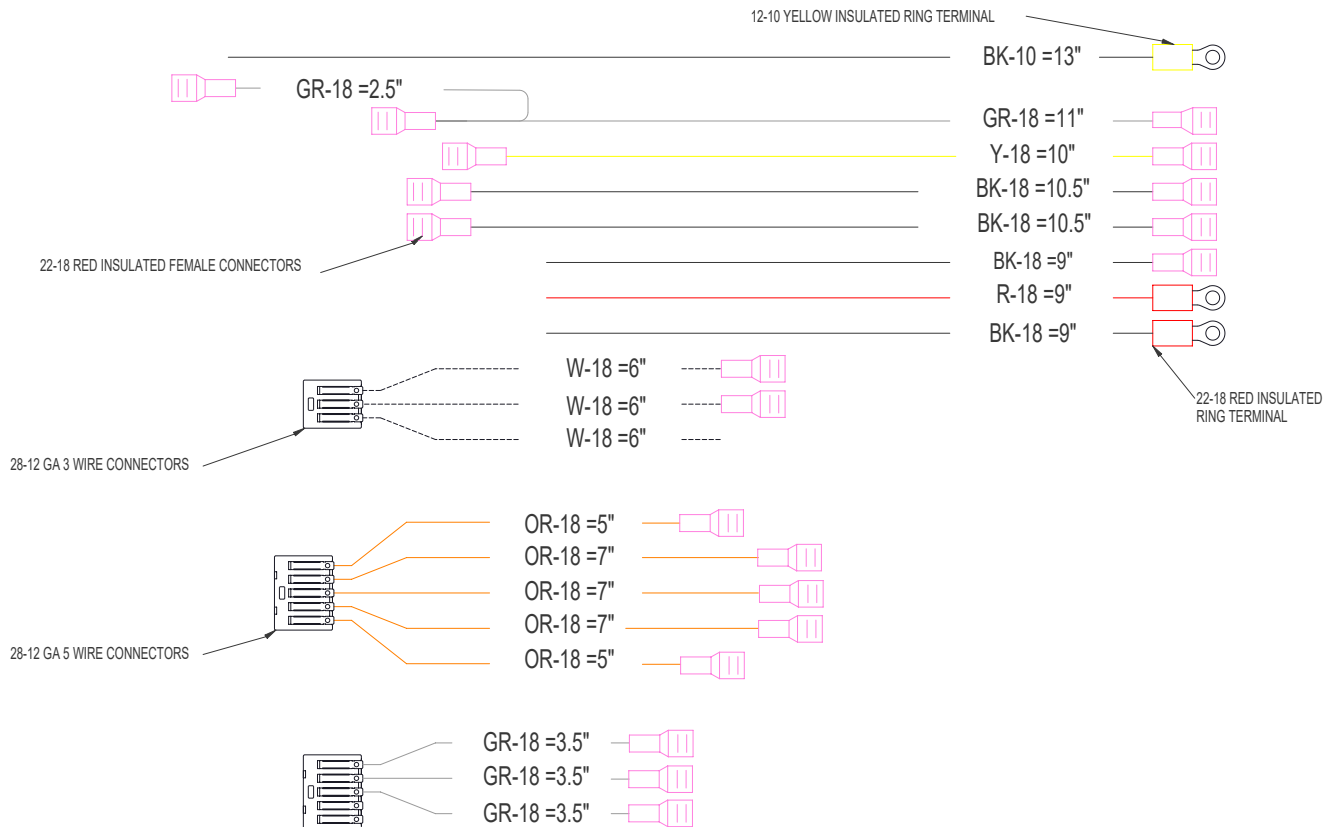

## UK1117 Wire Harness

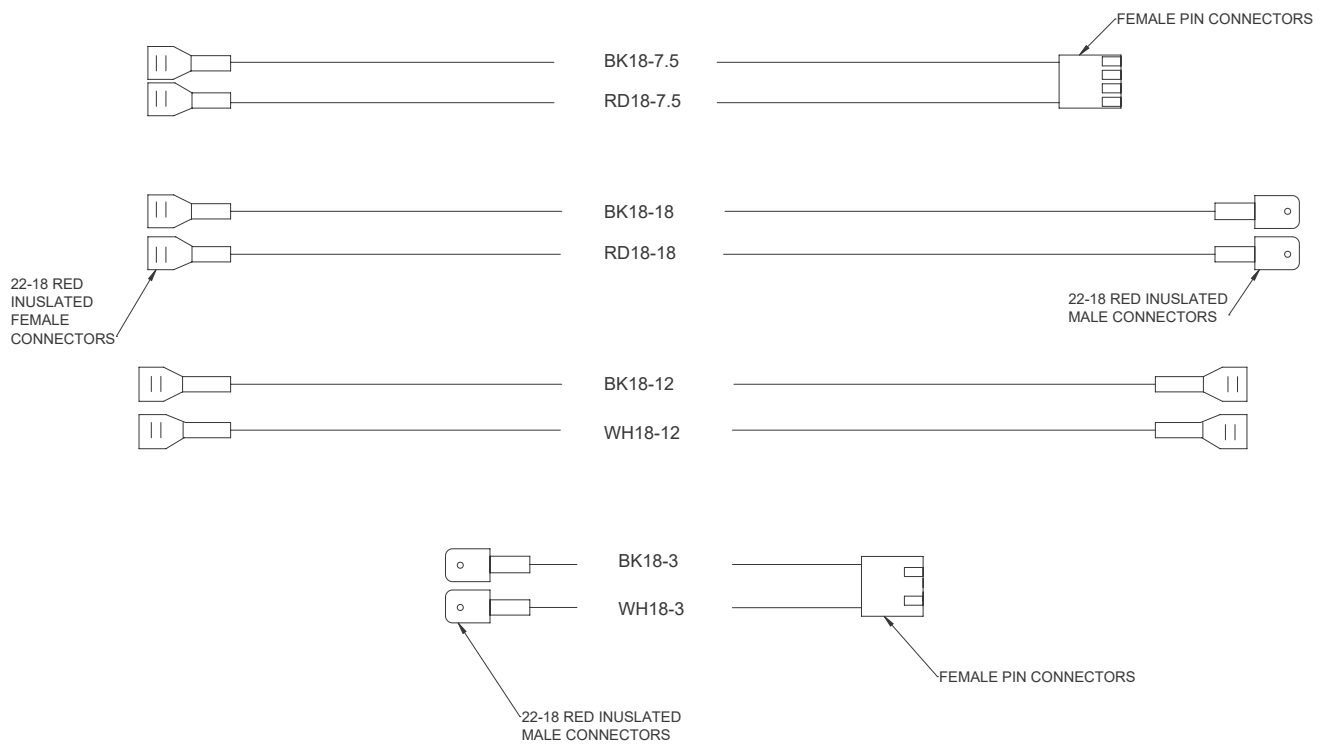

## Fast Timer Harness

